

Gerader Aufschraubanschluss

Baureihe K23

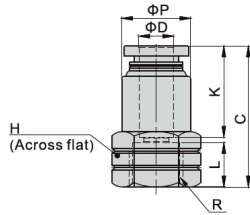

| Typ | øD | R | øP | L | C | K | H |
|---------|----|------|------|------|------|------|----|
| K235040 | 4 | M5 | 9 | 5 | 21 | 14 | 10 |
| K238040 | 4 | G1/8 | 9,5 | 8 | 23 | 14 | 14 |
| K234040 | 4 | G1/4 | 9,5 | 11 | 26 | 14 | 17 |
| K235060 | 6 | M5 | 12 | 5 | 21,5 | 16,5 | 12 |
| K238060 | 6 | G1/8 | 12,5 | 8 | 25,5 | 16,5 | 14 |
| K234060 | 6 | G1/4 | 12,5 | 11 | 28,5 | 16,5 | 17 |
| K233060 | 6 | G3/8 | 13 | 12 | 29,5 | 16,5 | 21 |
| K232060 | 6 | G1/2 | 13 | 13,5 | 31 | 16,5 | 25 |
| K238080 | 8 | G1/8 | 14 | 8 | 27,5 | 18,5 | 14 |
| K234080 | 8 | G1/4 | 14,5 | 11 | 30,5 | 18,5 | 17 |
| K233080 | 8 | G3/8 | 14,5 | 12 | 31,5 | 18,5 | 21 |
| K232080 | 8 | G1/2 | 14,5 | 13,5 | 33 | 18,5 | 25 |
| K238100 | 10 | G1/8 | 17 | 8 | 29 | 21 | 17 |
| K234100 | 10 | G1/4 | 17 | 11 | 33 | 21 | 17 |
| K233100 | 10 | G3/8 | 18 | 12 | 34 | 21 | 21 |
| K232100 | 10 | G1/2 | 18 | 13,5 | 35,5 | 21 | 25 |
| K234120 | 12 | G1/4 | 21 | 11 | 33,5 | 23 | 21 |
| K233120 | 12 | G3/8 | 21 | 12 | 35,5 | 23 | 21 |
| K232120 | 12 | G1/2 | 21 | 13,5 | 37 | 23 | 25 |